



45ft, Les Allen, 1985, Cruiser Style



BERTHS:



TOILET:

Thetford Cassette



HEATING:

-



SURVEY:

-



B.S.C:

Expires Jan 2023



BLACKING:

August 2018



ENGINE:

Nanni Diesel



LAYOUT:

Standard

Whilton
marina

Whilton Locks, Near Daventry,
Northants, NN11 2NH

01327 842577

sales@whiltonmarina.co.uk

www.whiltonmarina.co.uk

**For further information please see
a member of the sales team.**

It is the responsibility of the buyer to ensure that all particulars given in the course of the purchase of the boat are accurate. Such particulars are intended only as a guide and do not constitute a term of any contract.



Boat Specification

Plating Specification
Flat, V-Hull or Keeled
Fitted out By
Fixed Berths
Additional Berths

-
Flat Hull
Owner
Fixed Double Bed
Sofa Bed

Engine Specification

Engine Make
No. Of Cylinders
Keel, Water or Air Cooled
Gearbox Make
Aqua Drive
Bow Thruster
Diesel Tank Capacity

Nanni Diesel
-
Keel Cooled
-
No
No
-

Hot Water & Heating Systems

Source of Hot Water
Central Heating
Solid Fuel Stove
Water Tank Capacity
Material used
Additional Systems

Immersion & Engine
-
Arrow
-
-
-

Electrical System & Components

12 Volt Lighting
240 Volt Landline
Inverter
Generator
Batteries
Additional Systems

Yes
Yes
-
-
Three Domestic & One Starter
-

Bathroom Specification

Type Of Toilet
Bath Fitted
Separate Shower Fitted
Vanity Basin Fitted
Additional Systems

Thetford Cassette
Hip Bath
Over the bath
Yes
-

Kitchen Specification

Make & Model Of Cooker
Separate Hob
Microwave Fitted
Make & Model Of Fridge
Gas, 12 volt or 240 volt
Additional Systems

Calor
-
Yes
Yes
240 volt
-

Fit Out Materials

Insulation Used	-
Types Of Wood Used	-
Window Types	-
Materials Used	-
Bulls Eye, Pigeon Box or Houdini Hatch	-
Exterior Doors	-
Side Hatches	-
Front & Back Covers	-

History Of Vessel

Boat Safety Certificate	Expires Jan 2023
Last Hull Blacking	August 2018
Anodes	August 2018
Further Maintenance	-
Recent Survey	-
Additional Information	-

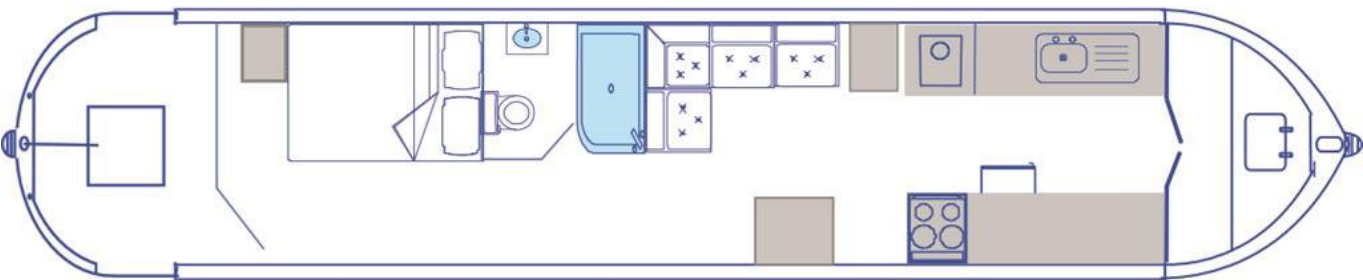



Whilton Locks, Near Daventry,
Northants, NN11 2NH
01327 842577
sales@whiltonmarina.co.uk
www.whiltonmarina.co.uk

**For further information please see
a member of the sales team.**

It is the responsibility of the buyer to ensure that all particulars given in the course of the purchase of the boat are accurate. Such particulars are intended only as a guide and do not constitute a term of any contract.

