



Hull to be insurable

55ft, John White, 1994, Traditional Style



**BERTHS:**

4



**TOILET:**

Cassette



**HEATING:**

Mikuni (requires attention)



**SURVEY:**

-



**B.S.C:**

Expires December 2025



**BLACKING:**

2019



**ENGINE:**

Beta 43



**LAYOUT:**

Standard

**Whilton  
marina**

Whilton Locks, Near Daventry,  
Northants, NN11 2NH

01327 842577

[sales@whiltonmarina.co.uk](mailto:sales@whiltonmarina.co.uk)

[www.whiltonmarina.co.uk](http://www.whiltonmarina.co.uk)

**For further information please see  
a member of the sales team.**

It is the responsibility of the buyer to ensure that all particulars given in the course of the purchase of the boat are accurate. Such particulars are intended only as a guide and do not constitute a term of any contract.



## Boat Specification

Plating Specification	8/6/4mm
Flat, V-Hull or Keeled	Flat Hull
Fitted out By	Unknown
Fixed Berths	Fixed double bed
Additional Berths	Pullman dinette converts to double bed

## Engine Specification

Engine Make	Beta 43
No. Of Cylinders	4 Cyl
Keel, Water or Air Cooled	Keel Cooled
Gearbox Make	PRM 150 D2
Aqua Drive	No
Bow Thruster	No
Diesel Tank Capacity	-

## Hot Water & Heating Systems

Source of Hot Water	Calorifier via engine
Central Heating	Mikuni (requires attention)
Solid Fuel Stove	Villager
Water Tank Capacity	-
Material used	-
Additional Systems	-

## Electrical System & Components

12 Volt Lighting	Yes
240 Volt Landline	Yes
Inverter	Heart Interface Freedom 20
Generator	-
Batteries	1x starter & 3x domestic
Additional Systems	-

## Bathroom Specification

Type Of Toilet	Cassette
Bath Fitted	Yes with shower
Separate Shower Fitted	No
Vanity Basin Fitted	Yes
Additional Systems	-

## Kitchen Specification

Make & Model Of Cooker	Country Leisure Caprice
Separate Hob	-
Microwave Fitted	-
Make & Model Of Fridge	In-Cuisine
Gas, 12 volt or 240 volt	240 volt
Additional Systems	-

## Fit Out Materials

Insulation Used  
Types Of Wood Used  
Window Types  
Materials Used  
Bulls Eye, Pigeon Box or Houdini Hatch  
Exterior Doors  
Side Hatches  
Front & Back Covers

Spray Foam  
T&G dark wood  
8 Hopper and 4 portholes  
Gold Anodised  
-  
Front - Wood, Back - Wood  
Yes x 1  
Front cratch and cover

## History Of Vessel

Boat Safety Certificate  
Last Hull Blacking  
Anodes  
Further Maintenance  
Recent Survey  
Additional Information

Expires December 2025  
2019  
2019  
-  
-  
Hull to be insurable

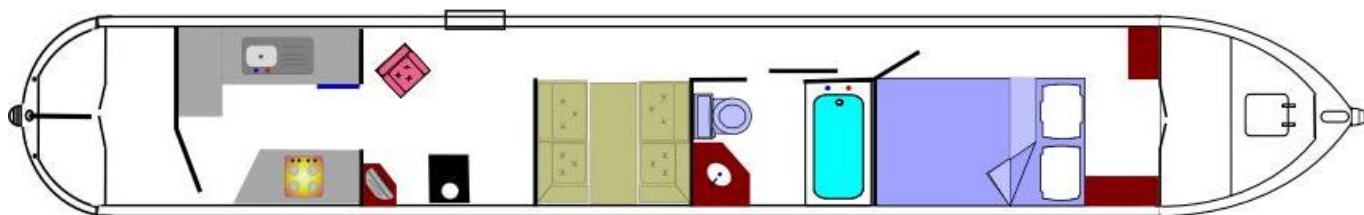





**Whilton  
marina**

Whilton Locks, Near Daventry,  
Northants, NN11 2NH  
01327 842577  
sales@whiltonmarina.co.uk  
www.whiltonmarina.co.uk

**For further information please see  
a member of the sales team.**

It is the responsibility of the buyer to ensure that all particulars given in the course of the purchase of the boat are accurate. Such particulars are intended only as a guide and do not constitute a term of any contract.

