



## 45ft, Clubline Cruisers, 1988, Traditional Style



**BERTHS:**

2



**TOILET:**

Porta-potti



**HEATING:**

None



**SURVEY:**

-



**B.S.C:**

September 2029



**BLACKING:**

2025



**ENGINE:**

BMC 1.5



**LAYOUT:**

Standard

**Whilton**  
marina

Whilton Locks, Near Daventry,  
Northants, NN11 2NH

01327 842577

[sales@whiltonmarina.co.uk](mailto:sales@whiltonmarina.co.uk)

[www.whiltonmarina.co.uk](http://www.whiltonmarina.co.uk)

**For further information please see  
a member of the sales team.**

It is the responsibility of the buyer to ensure that all particulars given in the course of the purchase of the boat are accurate. Such particulars are intended only as a guide and do not constitute a term of any contract.



## Boat Specification

Plating Specification	6/5/3
Flat, V-Hull or Keeled	Flat Hull
Fitted out By	Clubline
Fixed Berths	2
Additional Berths	Fold out double

## Engine Specification

Engine Make	BMC 1.5
No. Of Cylinders	-
Keel, Water or Air Cooled	Keel Cooled
Gearbox Make	Unknown
Aqua Drive	No
Bow Thruster	No
Diesel Tank Capacity	45 gallons approx

## Hot Water & Heating Systems

Source of Hot Water	Engine/Calorifier
Central Heating	None
Solid Fuel Stove	Morso
Water Tank Capacity	150 gallons approx
Material used	Stainless steel
Additional Systems	-

## Electrical System & Components

12 Volt Lighting	Yes
240 Volt Landline	Yes
Inverter	Lyvyan 2000/4000w
Generator	-
Batteries	1 domestic, 1 starter
Additional Systems	Solar panels

## Bathroom Specification

Type Of Toilet	Porta-potti
Bath Fitted	Hip bath
Separate Shower Fitted	Over the bath
Vanity Basin Fitted	Yes
Additional Systems	-

## Kitchen Specification

Make & Model Of Cooker	Statesman
Separate Hob	-
Microwave Fitted	-
Make & Model Of Fridge	None
Gas, 12 volt or 240 volt	-
Additional Systems	-



## Fit Out Materials

Insulation Used

Types Of Wood Used

Window Types

Materials Used

Bulls Eye, Pigeon Box or Houdini Hatch

Exterior Doors

Side Hatches

Front & Back Covers

Rockwool

Pine T&G

Hopper

Aluminium

-

Front - Wood, Back - Steel

Yes

Front cratch and cover

## History Of Vessel

Boat Safety Certificate

Last Hull Blacking

Anodes

Further Maintenance

Recent Survey

Additional Information

RCD/RCR Compliant?

Further Information

September 2029

2025

2025

New sureflo water pump fitted Aug '25

-

-

Not Applicable

-

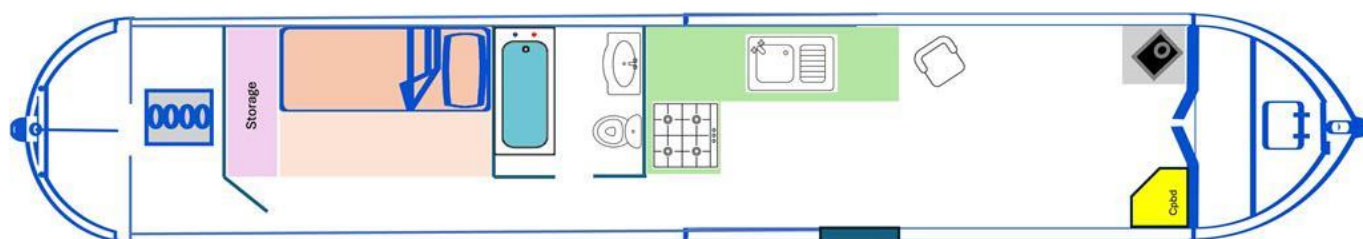





Whilton Locks, Near Daventry,  
Northants, NN11 2NH  
01327 842577  
sales@whiltonmarina.co.uk  
www.whiltonmarina.co.uk

**For further information please see  
a member of the sales team.**

It is the responsibility of the buyer to ensure that all particulars given in the course of the purchase of the boat are accurate. Such particulars are intended only as a guide and do not constitute a term of any contract.

