



60ft, Liverpool, 1994, Cruiser Style



BERTHS:

Four



TOILET:

New pump out and
tank & Thetford
cassette



HEATING:

Gas



SURVEY:

2018



B.S.C:

Expires 2022



BLACKING:

2018



ENGINE:

Reconditioned
BMC 1.8



LAYOUT:

Standard

Whilton
marina

Whilton Locks, Near Daventry,
Northants, NN11 2NH

01327 842577

sales@whiltonmarina.co.uk

www.whiltonmarina.co.uk

**For further information please see
a member of the sales team.**

It is the responsibility of the buyer to ensure that all particulars given
in the course of the purchase of the boat are accurate. Such
particulars are intended only as a guide and do not constitute a term
of any contract.



Boat Specification

Plating Specification
Flat, V-Hull or Keeled
Fitted out By
Fixed Berths
Additional Berths

8/6/4
Flat Hull
Professionally fitted out
Fixed double
Single in Dinette

Engine Specification

Engine Make
No. Of Cylinders
Keel, Water or Air Cooled
Gearbox Make
Aqua Drive
Bow Thruster
Diesel Tank Capacity

Reconditioned BMC 1.8
Four
Keel Cooled
-
No
No
45 gallons

Hot Water & Heating Systems

Source of Hot Water
Central Heating
Solid Fuel Stove
Water Tank Capacity
Material used
Additional Systems

240 volt/ Engine and gas
Gas
Hobbit
120 gallons
Integral
-

Electrical System & Components

12 Volt Lighting
240 Volt Landline
Inverter
Generator
Batteries
Additional Systems

Yes
Yes
Vectron inverter
-
3 new domestic and 1 new starter
Galvanic Isolator

Bathroom Specification

Type Of Toilet
Bath Fitted
Separate Shower Fitted
Vanity Basin Fitted
Additional Systems

New pump out and tank & Thetford cassette
-
Yes
Yes x2
New bathroom & bedroom floor, new shower tray, glass door, walls and fittings. new vanity cupboards and fittings

Kitchen Specification

Make & Model Of Cooker
Separate Hob
Microwave Fitted
Make & Model Of Fridge
Gas, 12 volt or 240 volt
Additional Systems

Statesman Legacy New 2018
-
-
Shoreline fridge with freezer compartment. New 2018
12 Volt
new work tops

Fit Out Materials

Insulation Used
Types Of Wood Used
Window Types
Materials Used
Bulls Eye, Pigeon Box or Houdini Hatch
Exterior Doors
Side Hatches
Front & Back Covers

Polystyrene
Oak + Teak T&G
Hopper
Aluminium
-
-
-
New Cratch cover & cabin cruiser hood and skirt.

History Of Vessel

Boat Safety Certificate
Last Hull Blacking
Anodes
Further Maintenance
Recent Survey
Additional Information

Expires 2022
2018
replaced 2018
-
2018
-

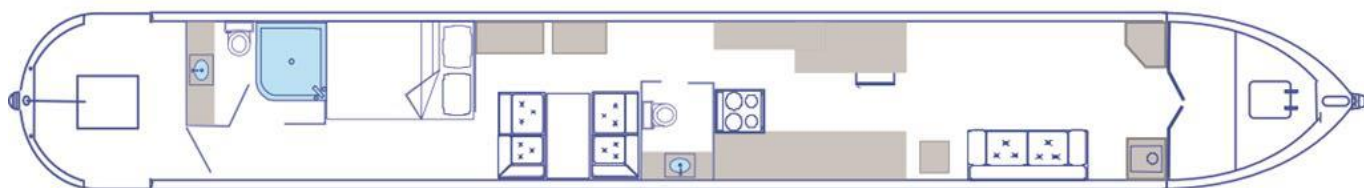



Whilton Locks, Near Daventry,
Northants, NN11 2NH
01327 842577
sales@whiltonmarina.co.uk
www.whiltonmarina.co.uk

**For further information please see
a member of the sales team.**

It is the responsibility of the buyer to ensure that all particulars given in the course of the purchase of the boat are accurate. Such particulars are intended only as a guide and do not constitute a term of any contract.

