



## 45ft, Harborough Boats, 1994, Semi-Traditional Style



### BERTHS:

Three



### TOILET:

Porta Potti



### HEATING:

Alde



### SURVEY:

2014



### B.S.C:

expires 2022



### BLACKING:

2014



### ENGINE:

BMC



### LAYOUT:

Standard

**Whilton**  
marina

Whilton Locks, Near Daventry,  
Northants, NN11 2NH

01327 842577

[sales@whiltonmarina.co.uk](mailto:sales@whiltonmarina.co.uk)

[www.whiltonmarina.co.uk](http://www.whiltonmarina.co.uk)

**For further information please see  
a member of the sales team.**

It is the responsibility of the buyer to ensure that all particulars given in the course of the purchase of the boat are accurate. Such particulars are intended only as a guide and do not constitute a term of any contract.



## Boat Specification

Plating Specification	8/6/4mm
Flat, V-Hull or Keeled	Flat Hull
Fitted out By	Harborough Boats
Fixed Berths	Single
Additional Berths	Pull Out Double

## Engine Specification

Engine Make	BMC
No. Of Cylinders	1.8
Keel, Water or Air Cooled	Keel Cooled
Gearbox Make	PRM
Aqua Drive	-
Bow Thruster	No
Diesel Tank Capacity	30 Gallons

## Hot Water & Heating Systems

Source of Hot Water	Alde & Engine
Central Heating	Alde
Solid Fuel Stove	Hobbit
Water Tank Capacity	120 Gallons
Material used	Integral
Additional Systems	-

## Electrical System & Components

12 Volt Lighting	Yes
240 Volt Landline	Yes
Inverter	-
Generator	-
Batteries	3 Domestic & 1 Starter
Additional Systems	New boat management unit

## Bathroom Specification

Type Of Toilet	Porta Potti
Bath Fitted	Hip Bath
Separate Shower Fitted	Yes
Vanity Basin Fitted	Yes
Additional Systems	-

## Kitchen Specification

Make & Model Of Cooker	Vanette 52
Separate Hob	-
Microwave Fitted	Yes
Make & Model Of Fridge	Electrolux
Gas, 12 volt or 240 volt	Gas
Additional Systems	-

## Fit Out Materials

Insulation Used  
Types Of Wood Used  
Window Types  
Materials Used  
Bulls Eye, Pigeon Box or Houdini Hatch  
Exterior Doors  
Side Hatches  
Front & Back Covers

Polystyrene  
Oak  
Hopper with fly screens  
Stainless Steel  
-  
-  
-  
Front cratch & cover, rear cover

## History Of Vessel

Boat Safety Certificate  
Last Hull Blacking  
Anodes  
Further Maintenance  
Recent Survey  
Additional Information

expires 2022  
2014  
2014  
-  
2014  
-

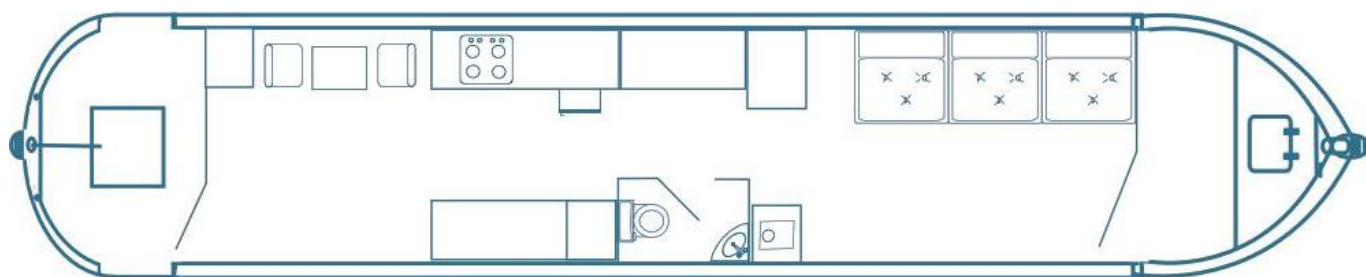





Whilton Locks, Near Daventry,  
Northants, NN11 2NH  
01327 842577  
sales@whiltonmarina.co.uk  
www.whiltonmarina.co.uk

**For further information please see  
a member of the sales team.**

It is the responsibility of the buyer to ensure that all particulars given in the course of the purchase of the boat are accurate. Such particulars are intended only as a guide and do not constitute a term of any contract.

