



62ft, Falcon, 1999, Semi-Traditional Style



BERTHS:

6



TOILET:

Mansfield Traveller
911 x 2



HEATING:

Alde Comfort



SURVEY:

December 2023



B.S.C:

New with sale



BLACKING:

Blacked April 2024



ENGINE:

Beta B43



LAYOUT:

Standard

Whilton
marina

Whilton Locks, Near Daventry,
Northants, NN11 2NH

01327 842577

sales@whiltonmarina.co.uk

www.whiltonmarina.co.uk

**For further information please see
a member of the sales team.**

It is the responsibility of the buyer to ensure that all particulars given in the course of the purchase of the boat are accurate. Such particulars are intended only as a guide and do not constitute a term of any contract.



Boat Specification

Plating Specification
Flat, V-Hull or Keeled
Fitted out By
Fixed Berths
Additional Berths

10/6/4mm
Flat Hull
Clifton Cruisers
Permanent double & two bunks
Sofa bed

Engine Specification

Engine Make
No. Of Cylinders
Keel, Water or Air Cooled
Gearbox Make
Aqua Drive
Bow Thruster
Diesel Tank Capacity

Beta B43
Four
Keel Cooled
PRM 160
-
No
60 gallons approx

Hot Water & Heating Systems

Source of Hot Water
Central Heating
Solid Fuel Stove
Water Tank Capacity
Material used
Additional Systems

Engine
Alde Comfort
-
100 gallons approx
Integral steel
-

Electrical System & Components

12 Volt Lighting
240 Volt Landline
Inverter
Generator
Batteries
Additional Systems

Yes
-
2500w
-
3 domestic, 1 starter
-

Bathroom Specification

Type Of Toilet
Bath Fitted
Separate Shower Fitted
Vanity Basin Fitted
Additional Systems

Mansfield Traveller 911 x 2
-
Yes
Yes
Second toilet & basin

Kitchen Specification

Make & Model Of Cooker
Separate Hob
Microwave Fitted
Make & Model Of Fridge
Gas, 12 volt or 240 volt
Additional Systems

Vanette GG7000
Vanette 4000/2
-
Shoreline
12 volt
-

Fit Out Materials

Insulation Used	Rockwool
Types Of Wood Used	Oak
Window Types	Double glazed
Materials Used	Aluminium frames
Bulls Eye, Pigeon Box or Houdini Hatch	-
Exterior Doors	-
Side Hatches	Yes
Front & Back Covers	-

History Of Vessel

Boat Safety Certificate	New with sale
Last Hull Blacking	Blacked April 2024
Anodes	6 new anodes April 2024
Further Maintenance	-
Recent Survey	December 2023
Additional Information	-

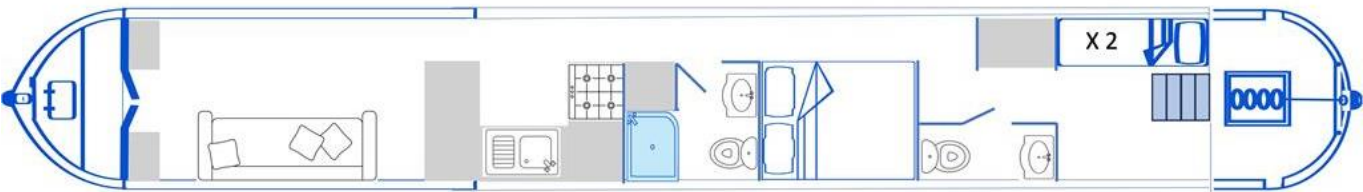



Whilton Locks, Near Daventry,
Northants, NN11 2NH
01327 842577
sales@whiltonmarina.co.uk
www.whiltonmarina.co.uk

**For further information please see
a member of the sales team.**

It is the responsibility of the buyer to ensure that all particulars given in the course of the purchase of the boat are accurate. Such particulars are intended only as a guide and do not constitute a term of any contract.