



36ft, Springer, 1989, Cruiser Style

**BERTHS:**

Two

**TOILET:**

Cassette Toilet

**HEATING:**

-

**SURVEY:**

-

**B.S.C:**

Expires March
2021

**BLACKING:**

November 2018

**ENGINE:**

Thornycroft

**LAYOUT:**

Standard

Whilton
marina

Whilton Locks, Near Daventry,
Northants, NN11 2NH

01327 842577

sales@whiltonmarina.co.uk

www.whiltonmarina.co.uk

**For further information please see
a member of the sales team.**

It is the responsibility of the buyer to ensure that all particulars given in the course of the purchase of the boat are accurate. Such particulars are intended only as a guide and do not constitute a term of any contract.



Boat Specification

| | |
|------------------------|------------------------------|
| Plating Specification | - |
| Flat, V-Hull or Keeled | V-Hull |
| Fitted out By | Professional |
| Fixed Berths | - |
| Additional Berths | L Shape converts to a double |

Engine Specification

| | |
|---------------------------|-------------|
| Engine Make | Thornycroft |
| No. Of Cylinders | Three |
| Keel, Water or Air Cooled | Keel Cooled |
| Gearbox Make | - |
| Aqua Drive | No |
| Bow Thruster | No |
| Diesel Tank Capacity | - |

Hot Water & Heating Systems

| | |
|---------------------|----------------|
| Source of Hot Water | Rinnai Gas |
| Central Heating | - |
| Solid Fuel Stove | Yes |
| Water Tank Capacity | - |
| Material used | Integral steel |
| Additional Systems | - |

Electrical System & Components

| | |
|--------------------|----------------------------|
| 12 Volt Lighting | Yes |
| 240 Volt Landline | Yes |
| Inverter | - |
| Generator | - |
| Batteries | Two Domestic & One Starter |
| Additional Systems | - |

Bathroom Specification

| | |
|------------------------|-----------------|
| Type Of Toilet | Cassette Toilet |
| Bath Fitted | - |
| Separate Shower Fitted | - |
| Vanity Basin Fitted | - |
| Additional Systems | - |

Kitchen Specification

| | |
|--------------------------|--------|
| Make & Model Of Cooker | Moffat |
| Separate Hob | - |
| Microwave Fitted | - |
| Make & Model Of Fridge | - |
| Gas, 12 volt or 240 volt | - |
| Additional Systems | - |

Fit Out Materials

Insulation Used
Types Of Wood Used
Window Types
Materials Used
Bulls Eye, Pigeon Box or Houdini Hatch
Exterior Doors
Side Hatches
Front & Back Covers

-
-
-
-
-
Front - Wood, Back - Wood
-
-

History Of Vessel

Boat Safety Certificate
Last Hull Blacking
Anodes
Further Maintenance
Recent Survey
Additional Information

Expires March 2021
November 2018
June 2014
New alternator, Thermostat, gas valve- August 2018
-
-

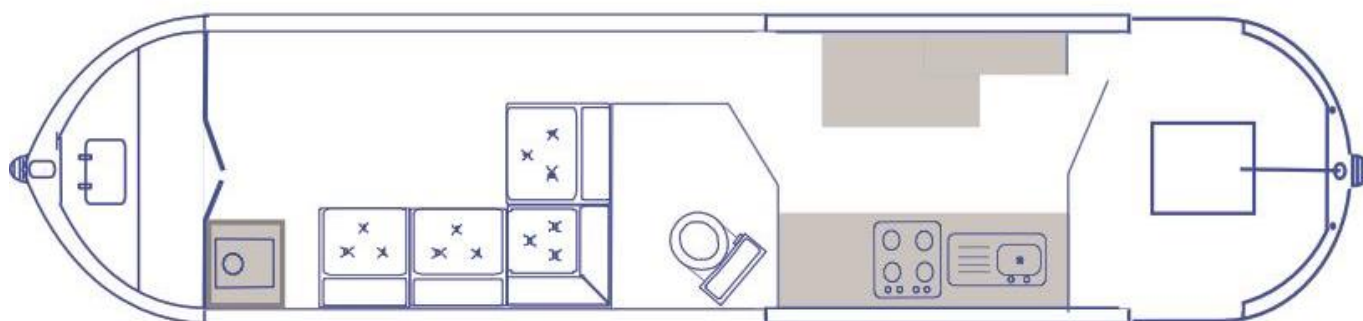



Whilton Locks, Near Daventry,
Northants, NN11 2NH
01327 842577
sales@whiltonmarina.co.uk
www.whiltonmarina.co.uk

**For further information please see
a member of the sales team.**

It is the responsibility of the buyer to ensure that all particulars given in the course of the purchase of the boat are accurate. Such particulars are intended only as a guide and do not constitute a term of any contract.